

7835 MECHANICAL SERVICES SCHEDULE OF DRAWINGS		
DWG#:	SHEET TITLE	SCALE
M01	SCHEDULE OF DRAWINGS / LEGENDS / ABBREVIATIONS / LOCALITY PLAN	NTS
M02	SPECIFICATION & SCOPE OF WORKS / SCHEDULE OF SPLIT AIR CONDITIONING UNITS / SCHEDULE OF FANS & DOOR GRILLES	NTS
M03	PROPOSED SITE PLAN MECHANICAL SERVICES LAYOUTS	NTS
M04	PROPOSED GROUND FLOOR PLAN MECHANICAL SERVICES LAYOUTS	1 : 100 @ A3
M05	PROPOSED SITE SECTION A & SITE SECTION C MECHANICAL SERVICES LAYOUTS	AS SHOWN
M06	MECHANICAL SERVICES DETAILS	NTS

ABBREVIATIONS	
	CIRCLE WITHIN DIAMOND ENCLOSED LETTER INDICATES SPECIFIC NOTE REFERENCE ON SAME SHEET
	TRIANGLE WITH A NUMBER INSIDE INDICATES DRAWING REVISION
	D# : INDICATES THE DETAIL NUMBER M## : INDICATES THE SHEET NUMBER

ABBREVIATIONS	
CCU	CEILING CASSETTE UNIT
ODU	OUTDOOR UNIT
EAF	EXHAUST AIR FAN
DG	DOOR GRILLE
GF	GROUND FLOOR
NTS	NOT TO SCALE
F/B	FROM BELOW
T/A	TO ABOVE



GOOGLE EARTH - LOCALITY PLAN
NTS

MECHANICAL SERVICES LEGEND	
SYMBOLS	DESCRIPTIONS
	WIRED THERMOSTAT OR TEMPERATURE CONTROL
	AIR CONDITIONING CONDENSATE DRAIN PIPEWORK
	AIR CONDITIONING REFRIGERANT PIPEWORK
	AIR CONDITIONING THERMOSTAT CONTROL WIRE / WIRELESS CONNECTION (INDICATIVE ONLY)
	PIPEWORK RISING / DROPPING
	EAF-1 WALL MOUNTED EXHAUST AIR FAN
	CCU-GF-1 CEILING CASSETTE UNIT INDOOR UNIT NUMBER (SEE SCHEDULE ON M02 SHEET) FLOOR LEVEL TYPE
	WMU-GF-1 WALL MOUNTED UNIT INDOOR UNIT NUMBER (SEE SCHEDULE ON M02 SHEET) FLOOR LEVEL TYPE
	ODU-GF-1 WALL MOUNTED / CASSETTE OUTDOOR UNIT OUTDOOR UNIT NUMBER (SEE SCHEDULE ON M01) FLOOR LEVEL
	DG1 DOOR GRILLE
	25mm 25mm DOOR UNDERCUT

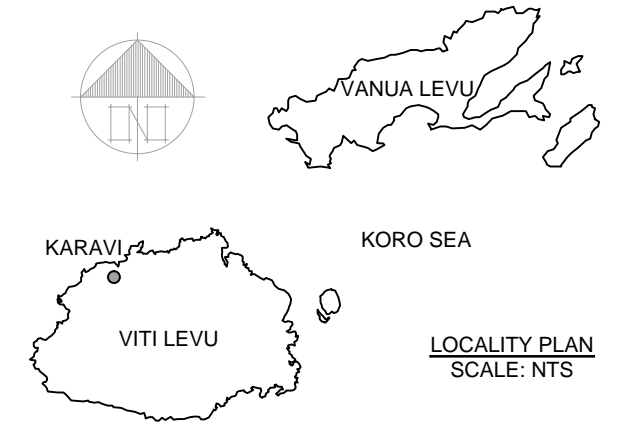

<small>© COPYRIGHT OF THIS DRAWING SHALL REMAIN THE PROPERTY OF IRWIN ALSOP PACIFIC PTE LTD. PRECEDENCE SHALL BE GIVEN TO THE LARGEST SCALE DRAWING. THE CONTRACTOR SHALL VERIFY ALL DIMENSIONS ON SITE PRIOR TO PREPARATION OF SHOP DRAWINGS OR COMMENCEMENT OF ANY WORK. THE ENGINEER SHALL BE NOTIFIED IMMEDIATELY OF ANY DISCREPANCIES.</small>	LEAD CONSULTANT / BUILDING SERVICES ENGINEERS: 19 DOMAIN ROAD, DOMANU SUVA, FIJI ISLANDS P.O. BOX 3872 SAMABULA, FIJI TELEPHONE: +679 330 2819 FACSIMILE: +679 330 2161 E-Mail: office@iap.com.fj	ARCHITECT: Architects + Master Planning 88 MCGREGOR ROAD, SUVA, FIJI ISLANDS TEL: (679) 330 4043 FAX: (679) 330 4496 E-Mail: conway@carc.com.fj	CLIENT: LAND TRANSPORT AUTHORITY LOT 1, DANIVA ROAD, VALELEVU NASINU, FIJI ISLANDS P.O. BOX 6676, NASINU, FIJI TELEPHONE: +679 339 2166 FACSIMILE: +679 339 8925	PROJECT: LTA KARAVI WEIGHBRIDGE STATION KINGS ROAD, BA, FIJI ISLANDS	SHEET TITLE: SCHEDULE OF DRAWINGS / LEGENDS / ABBREVIATIONS / LOCALITY PLAN	DRAWING STATUS: FOR TENDER FOR PRICING FINAL DESIGN	DESIGNED: JL CHECKED: JL / RL START DATE: 25 / 04 / 2018 SCALE: NTS	DRAWN: MM APPROVED: WY ISSUE DATE: 24 / 05 / 2019	DISCIPLINE / SERVICES: MECHANICAL	JOB No: 7835 DWG No: M01 REVISION No: -	
	No: 1 DATE: 24/05/2019 DESCRIPTION: FOR TENDER BY: IAP										

SPECIFICATIONS AND SCOPE OF WORKS

A. GENERAL

1. ALL MATERIALS AND WORKMANSHIP SHALL BE IN ACCORDANCE WITH RELEVANT CODES AND AUTHORITIES HAVING JURISDICTION.
2. ALL DIMENSIONS AND FINAL POSITION ARE TO BE CONFIRMED AND SERVICES CO-ORDINATED BEFORE COMMENCING CONSTRUCTION. ALL SERVICES ROUTES, PENETRATIONS AND EQUIPMENT LOCATIONS TO BE CO-ORDINATED WITH THE STRUCTURE. ALL FINAL POSITIONS OF EQUIPMENT(S) AND MOUNTING TO BE CONFIRMED ON SITE WITH THE PROJECT MANAGER.
3. CHECK AND CONFIRM RELEVANT LEVELS AND DIMENSIONS ON SITE PRIOR TO COMMENCEMENT OF FABRICATION AND INSTALLATION OF WORKS WITH THE PROJECT MANAGER.
4. THE ROUTE AND PENETRATION FOR REFRIGERANT, CONDENSATE DRAIN PIPEWORKS AND DUCTWORKS TO BE CONFIRMED AND MARKED ON SITE WITH THE PROJECT MANAGER.

B. AIR CONDITIONING

1. ALL AIR CONDITIONING UNITS SHALL COMPLY WITH MINIMUM ENERGY PERFORMANCE (MEPS) REQUIREMENTS AS STATED IN AS/NZS 3823
2. ALL REFRIGERANT AND CONDENSATE DRAIN PIPE SIZE TO BE AS PER THE MANUFACTURER'S SPECIFICATION AND INSULATED WITH AEROFLEX 25MM WALL INSULATION. ALL REFRIGERANT AND CONDENSATE DRAIN PIPE TO BE CONCEALED.
3. THE LOCATION OF THE THERMOSTAT AND TEMPERATURE CONTROLS TO BE CONFIRMED ON SITE.
4. SUPPLY AND INSTALL SLIMDUCT SD SERIES WITH PROPRIETY FITTINGS TO CONCEAL CABLINGS AND REFRIGERATION PIPEWORKS BETWEEN OUTDOOR UNITS AND BUILDING EXPOSED TO VIEW. THE COLOUR OF THE SLIMDUCT SD SERIES TO MATCH THE COLOUR OF THE WALL.

C. ELECTRICAL

1. THE MECHANICAL SUB-CONTRACTOR SHALL PROVIDE COMPLETE ELECTRICAL CONNECTIONS OF AIR CONDITIONING UNIT / EXHAUST FAN TO THE WEATHERPROOF ISOLATOR MOUNTED NEXT TO THE OUTDOOR UNIT PROVIDED BY THE ELECTRICAL SUB-CONTRACTOR.

SCHEDULE OF FANS		
ITEM NUMBER	DESCRIPTIONS	SERIES
EAF - 1	FANTECH WALL MOUNTED FAN MODEL: EIE150 (Med speed) RATED AT 50L/s @ 50Pa. FAN TO BE INTERLOCKED WITH TOILET LIGHT	EZIFIT IN-WALL EXHAUST FAN
EAF - 2	FANTECH WALL MOUNTED FAN MODEL: EIE150 (High speed) RATED AT 110L/s @ 50Pa. FAN TO BE INTERLOCKED WITH TOILET LIGHT	EZIFIT IN-WALL EXHAUST FAN

SCHEDULE OF SPLIT AIR CONDITIONING UNITS				
ITEM NUMBER	COOLING CAPACITY (KW)	MODEL -DAIKIN (OR APPROVED EQUIVALENT)	TYPE	REMARKS
CCU-GF-1	3.6	FFRN35CXV1	CEILING CASSETTE UNIT	SUPPLY AND INSTALL
ODU-GF-1	3.6	RN35CXV1	OUTDOOR UNIT	SUPPLY AND INSTALL
CCU-GF-2	2.7	FFRN25CXV1	CEILING CASSETTE UNIT	SUPPLY AND INSTALL
ODU-GF-2	2.7	RN25CXV1	OUTDOOR UNIT	SUPPLY AND INSTALL
CCU-GF-3	3.6	FFRN35CXV1	CEILING CASSETTE UNIT	SUPPLY AND INSTALL
ODU-GF-3	3.6	RN35CXV1	OUTDOOR UNIT	SUPPLY AND INSTALL
WMU-GF-4	2.6	FTN25HV1G	WALL MOUNTED UNIT	SUPPLY AND INSTALL
ODU-GF-4	2.6	RN25HV1G	OUTDOOR UNIT	SUPPLY AND INSTALL
WMU-GF-5	3.7	FTN35HV1G	WALL MOUNTED UNIT	SUPPLY AND INSTALL
ODU-GF-5	3.7	RN35HV1G	OUTDOOR UNIT	SUPPLY AND INSTALL
WMU-GF-6	3.7	FTN35HV1G	WALL MOUNTED UNIT	SUPPLY AND INSTALL
ODU-GF-6	3.7	RN35HV1G	OUTDOOR UNIT	SUPPLY AND INSTALL

SCHEDULE OF DOOR GRILLE		
ITEM NUMBER	DESCRIPTIONS	SERIES
DG1	HOLYOAKE - SERIES DG-52 BFL 450 x 150 DOOR GRILLE	HOLYOAKE DG-52

© COPYRIGHT OF THIS DRAWING SHALL REMAIN THE PROPERTY OF IRWIN ALSOP PACIFIC PTE LTD. PRECEDENCE SHALL BE GIVEN TO THE LARGEST SCALE DRAWING. THE CONTRACTOR SHALL VERIFY ALL DIMENSIONS ON SITE PRIOR TO PREPARATION OF SHOP DRAWINGS OR COMMENCEMENT OF ANY WORK. THE ENGINEER SHALL BE NOTIFIED IMMEDIATELY OF ANY DISCREPANCIES.	LEAD CONSULTANT / BUILDING SERVICES ENGINEERS:  19 DOMAIN ROAD, DOMAIN SUVA, FIJI ISLANDS P.O. BOX 3872 SAMABULA, FIJI TELEPHONE: +679 330 2819 FACSIMILE: +679 330 2165 E-Mail: office@iap.com.fj	ARCHITECT:  88 MCGREGOR ROAD, SUVA, FIJI ISLANDS TEL: (679) 330 4043 FAX: (679) 330 4496 E-Mail: conway@carc.com.fj	CLIENT:  LAND TRANSPORT AUTHORITY LOT 1, DANIVA ROAD, VALELEVU NASINU, FIJI ISLANDS P.O. BOX 6676, NASINU, FIJI TELEPHONE: +679 339 2166 FACSIMILE: +679 339 8925	PROJECT: LTA KARAVI WEIGHBRIDGE STATION KINGS ROAD, BA, FIJI ISLANDS	SHEET TITLE: SPECIFICATION & SCOPE OF WORKS / SCHEDULE OF SPLIT AIR CONDITIONING UNITS / SCHEDULE OF FANS & DOOR GRILLES	DRAWING STATUS: FOR TENDER FOR PRICING FINAL DESIGN	DESIGNED: JL CHECKED: JL / RL START DATE: 25 / 04 / 2018 SCALE: NTS	DRAWN: MM APPROVED: WY ISSUE DATE: 24 / 05 / 2019	DISCIPLINE / SERVICES: MECHANICAL		
							JOB No: 7835 DWG No: M02 REVISION No: -				

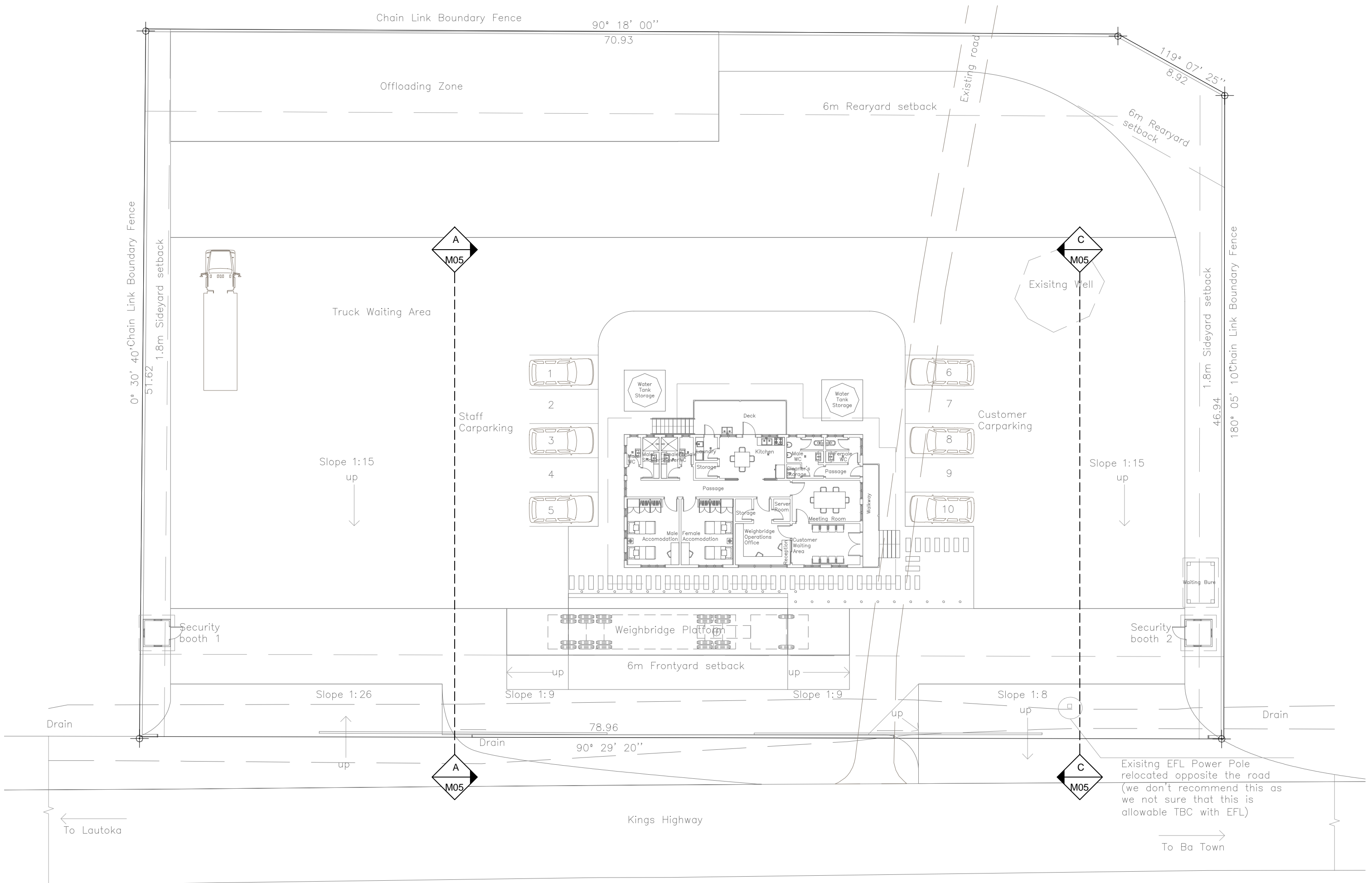

<p>© COPYRIGHT OF THIS DRAWING SHALL REMAIN THE PROPERTY OF IRWIN ALSOP PACIFIC PTE LTD. PRECEDENCE SHALL BE GIVEN TO THE LARGEST SCALE DRAWING. THE CONTRACTOR SHALL VERIFY ALL DIMENSIONS ON SITE PRIOR TO PREPARATION OF SHOP DRAWINGS OR COMMENCEMENT OF ANY WORK. THE ENGINEER SHALL BE NOTIFIED IMMEDIATELY OF ANY DISCREPANCIES.</p>	<p>LEAD CONSULTANT / BUILDING SERVICES ENGINEERS:</p> <p>IAP Irwin Alsop Pacific 19 DOMAIN ROAD, DOMANI SUVA, FIJI ISLANDS P.O. BOX 3872 SAMABUSA, FIJI TELEPHONE: +679 330 2819 FACSIMILE: +679 330 2161 E-Mail: office@iap.com.fj</p>	<p>ARCHITECT:</p> <p>conway architects Architects + Master Planning 88 MCGREGOR ROAD, SUVA, FIJI ISLANDS TEL: (679) 330 4043 FAX: (679) 330 4496 E-Mail: conway@carc.com.fj</p>	<p>CLIENT:</p> <p>LTA LAND TRANSPORT AUTHORITY LOT 1, DANIVA ROAD, VALELEVU NASINU, FIJI ISLANDS P.O. BOX 6676, NASINU, FIJI TELEPHONE: +679 339 2166 FACSIMILE: +679 339 8925</p>	<p>PROJECT:</p> <p>LTA KARAVI WEIGHBRIDGE STATION KINGS ROAD, BA, FIJI ISLANDS</p>	<p>SHEET TITLE:</p> <p>PROPOSED SITE PLAN MECHANICAL SERVICES LAYOUTS</p>	<p>DRAWING STATUS:</p> <p>FOR TENDER FOR PRICING FINAL DESIGN</p>	<p>DESIGNED: JL</p>	<p>DRAWN: MM</p>	<p>DISCIPLINE / SERVICES:</p> <p>MECHANICAL</p>
							<p>CHECKED: JL / RL</p>	<p>APPROVED: WY</p>	



NOTES:

CONDENSATE DRAIN PIPE DROP WITHIN WALL CAVITY AND DISCHARGE TO THE TUNDISH AT HAND BASIN / SINK WASTE PIPE. (TYPICAL)

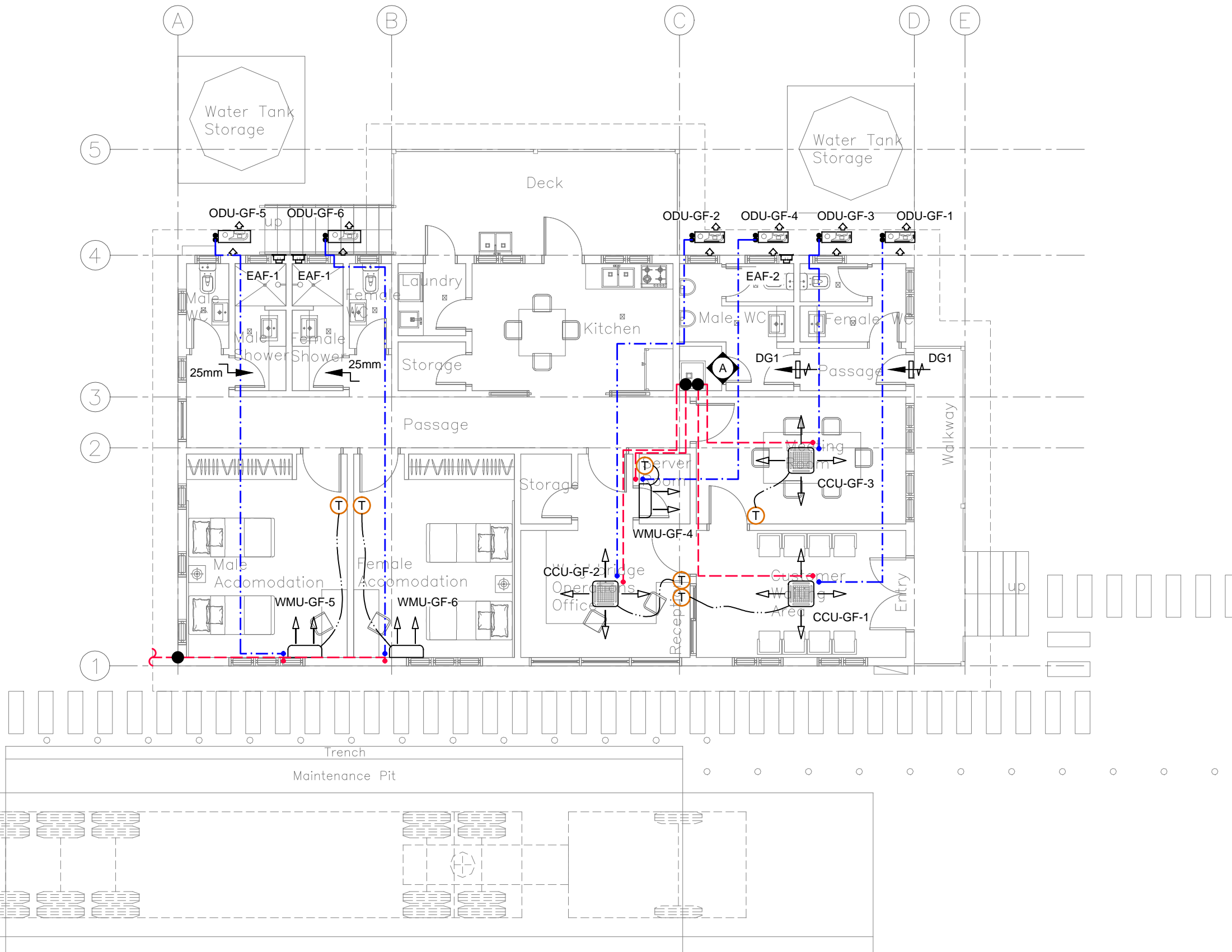

<p>© COPYRIGHT OF THIS DRAWING SHALL REMAIN THE PROPERTY OF IRWIN ALSOP PACIFIC PTE LTD. PRECEDENCE SHALL BE GIVEN TO THE LARGEST SCALE DRAWING. THE CONTRACTOR SHALL VERIFY ALL DIMENSIONS ON SITE PRIOR TO PREPARATION OF SHOP DRAWINGS OR COMMENCEMENT OF ANY WORK. THE ENGINEER SHALL BE NOTIFIED IMMEDIATELY OF ANY DISCREPANCIES.</p> <p>19 DOMAIN ROAD, DOMANI SUVA, FIJI ISLANDS P.O. BOX 3872 SAMABUSA, FIJI TELEPHONE: +679 330 2819 FACSIMILE: +679 330 2161 E-Mail: office@iap.com.fj</p>	<p>LEAD CONSULTANT / BUILDING SERVICES ENGINEERS:</p>		<p>ARCHITECT:</p> <p>Architects + Master Planning 88 MCGREGOR ROAD, SUVA, FIJI ISLANDS TEL: (679) 330 4043 FAX: (679) 330 4496 E-Mail: conway@carc.com.fj</p>	<p>CLIENT:</p> <p>LAND TRANSPORT AUTHORITY LOT 1, DANIVA ROAD, VALELEVU NASINU, FIJI ISLANDS P.O. BOX 6676, NASINU, FIJI TELEPHONE: +679 339 2166 FACSIMILE: +679 339 8925</p>	<p>PROJECT:</p> <p>LTA KARAVI WEIGHBRIDGE STATION KINGS ROAD, BA, FIJI ISLANDS</p>	<p>SHEET TITLE:</p> <p>PROPOSED GROUND FLOOR PLAN MECHANICAL SERVICES LAYOUTS</p>	<p>DRAWING STATUS:</p> <p>FOR TENDER</p> <p>ACTION:</p> <p>FOR PRICING</p> <p>WORK STAGE:</p> <p>FINAL DESIGN</p>	<p>DESIGNED: JL</p> <p>CHECKED: JL / RL</p> <p>START DATE: 25 / 04 / 2018</p> <p>SCALE: 1 : 100 @ A3</p>	<p>DRAWN: MM</p> <p>APPROVED: WY</p> <p>ISSUE DATE: 24 / 05 / 2019</p>	<p>DISCIPLINE / SERVICES:</p> <p>MECHANICAL</p>		
	<p>No: DATE DESCRIPTION</p>		<p>BY:</p>				<p>JOB No:</p> <p>7835</p>	<p>DWG No:</p> <p>M04</p>	<p>REVISION No:</p> <p>-</p>			
	<p>1 24/05/2019 FOR TENDER</p>		<p>IAP</p>									

